

Suporte Pedestal para TV - RACK-100

Instruções de Montagem

Lista de Componentes

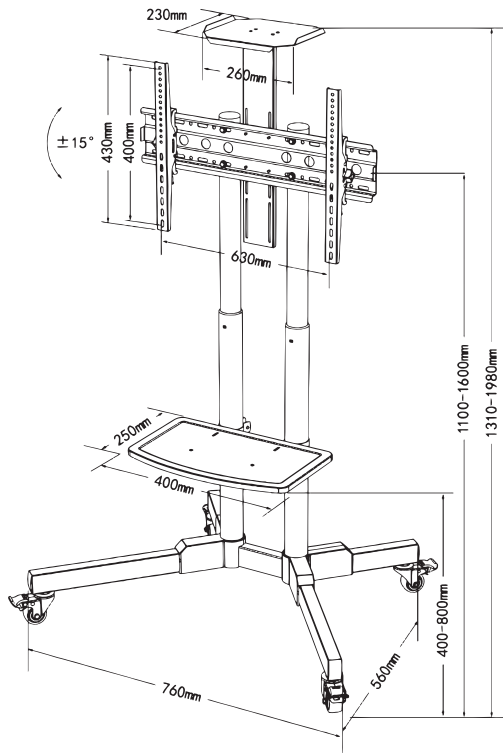

C-A - 1x Tubo Soldado

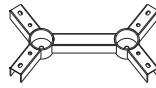

C-B - 2x Pernas Dianteiras

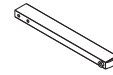

C-C - 2x Pernas Traseiras



C-D - 4x Rodízios



C-E - 2x Capa de Plástico



C-F - 2x hastes telescópicas

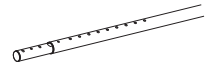

C-G - 1x Prateleira AV

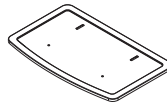

C-H - 2x Suporte de Prateleira

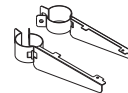

C-I - 1x Suporte de TV

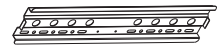

C-J - 1x suporte de prateleira superior

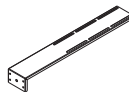

C-K - 1x Prateleira AV superior



C-L - 2x Braços esquerdo e direito

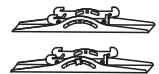

Lista de Parafusos

A - 4x M4x14



B - 4x M6x25

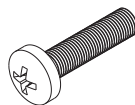

C - 4x M8x25

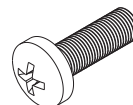

D - 4x Arruela M6



E - 8x Espaçadores Plásticos

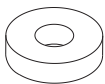

F - 12x M8x65

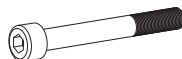

G - 14x Arruela M8



H - 11x Porca M8



I - 1x Chave Allen N.6



J - 4x M6x10



K - 6x M5x8



L - 2x M8x40

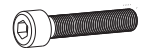

M - 2x M8x25



AQUÁRIO

Passo a passo da instalação

Passo 1 - Anexando Rodízios à Base

Certifique-se de que todos os parafusos estão presos usando a chave!

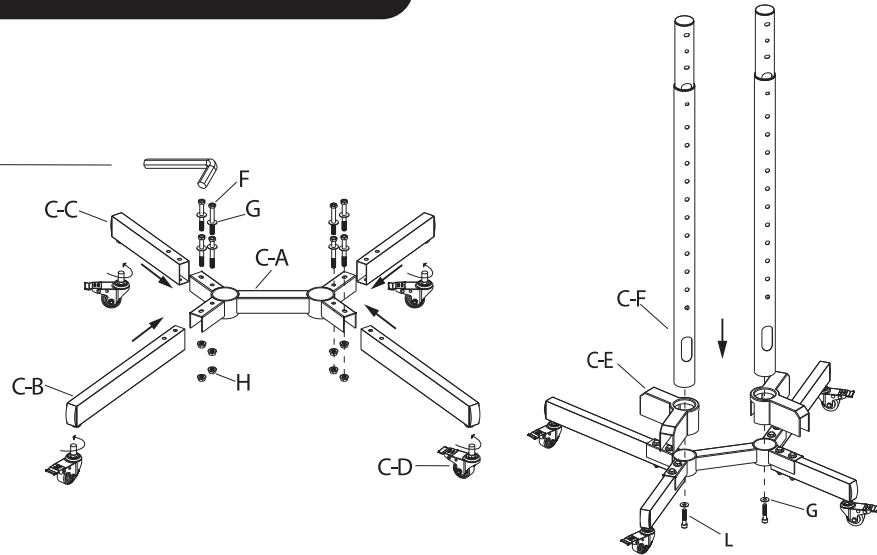

Passo 2 - Instalação da Haste Telescópica e Prateleira

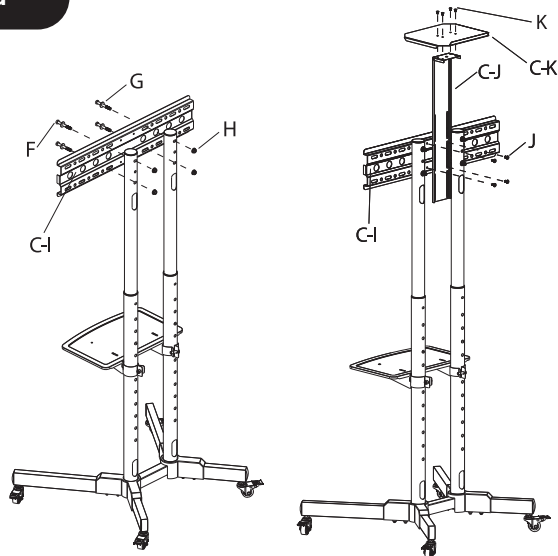
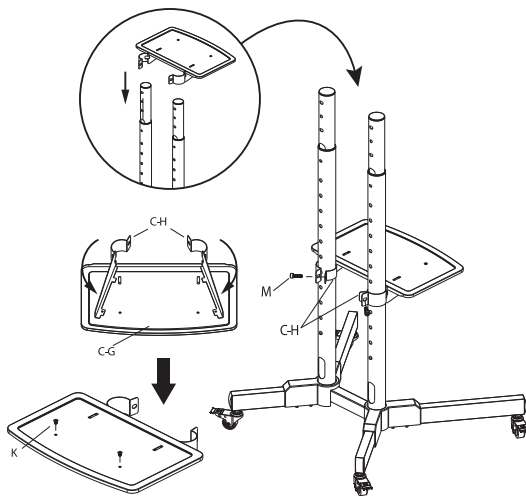

Passo 3 - Instalação de Suporte de Montagem e Televisão

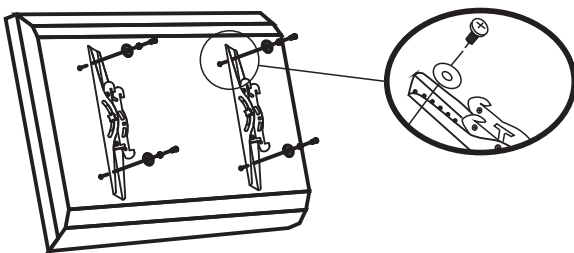

1. Este suporte móvel foi projetado para caber na maioria das televisões de tela plana de 32" a 70" com peso de até 59kg.

2. Suporta televisores com furos de montagem de até 23,6" na horizontal e 16" na vertical.

VESA: 100x100 | 200x200 | 200x300 | 300x200 | 300x300
400x200 | 400x300 | 400x400 | 600x200 | 600x400

3. Altura ajustável variando de 1100-1600mm proporciona uma visualização confortável.

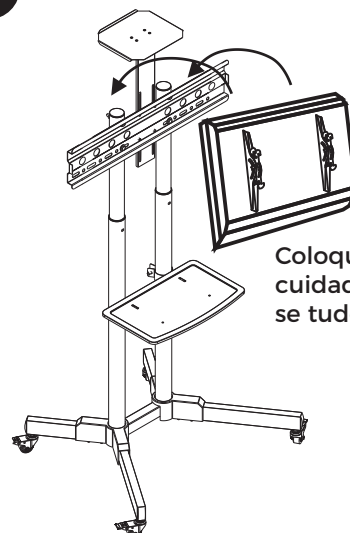

Coloque a TV com cuidado e verifique se tudo está preso!